

"FOCUS"

Integrated art project for an in-between area playground.
 Fagerlund primary school, Brumunddal. 2005.
 Sculpted amphi, 10 satellite objects where of 4 are turnable, and 3 with light.
 Concrete; ordinary gray and black, high polished.

Client: Ringsaker Municipality
 Art Consultant: Bodil Buchacz, email: bodilbuchacz@gmail.com
 Comissioned after art competition.

How to make a living playground? What do children want?

To my opinion, the original plan was a stiff, designed playground, to propose a not-integrated art project here would not make this impression any better!
 Therefore I chose the main object in the site, - the amphi, to become a site specific sculpture. I transformed the ordinary amphi into a sculpted landscape, a "bird cliff" for children, with several new private places to sit in, to hide in and to play with. Forms and places to be filled with there own stories.

Then I asked myself; what can be re-used from the original plan, integrated in my plan?

The result is an integrated art project crossing borders between landscape architecture, landart and sculpture. And to bring a project like this to fruition, presuppose good coomunication and collaboration between purchaser, architects, engineers, constructors and myself.

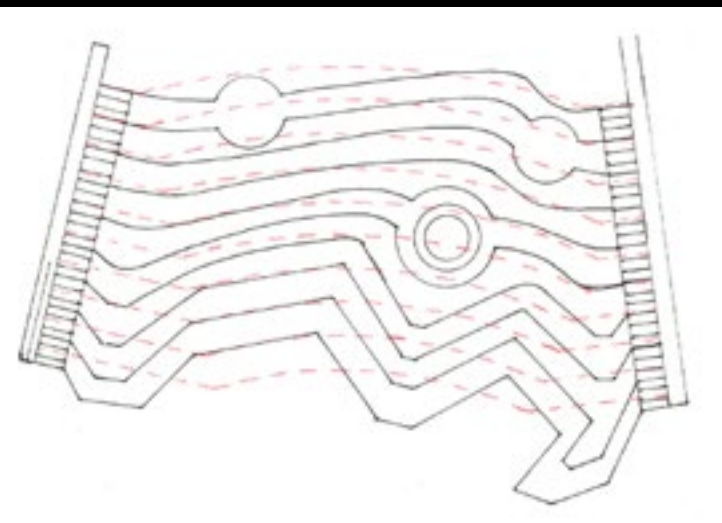

The sculpted amphi versus the original designed amphi.

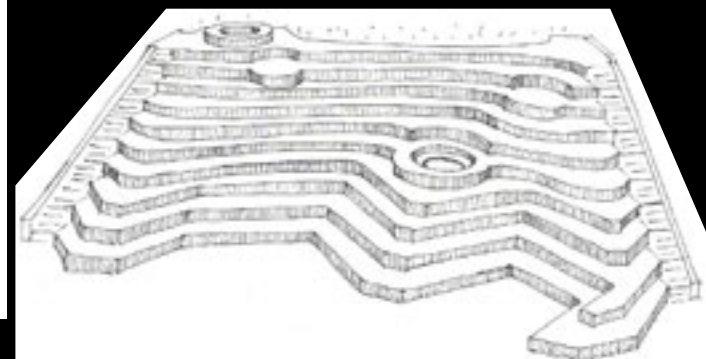

The sculpted amphi becomes a new landscape and the school's new playground!

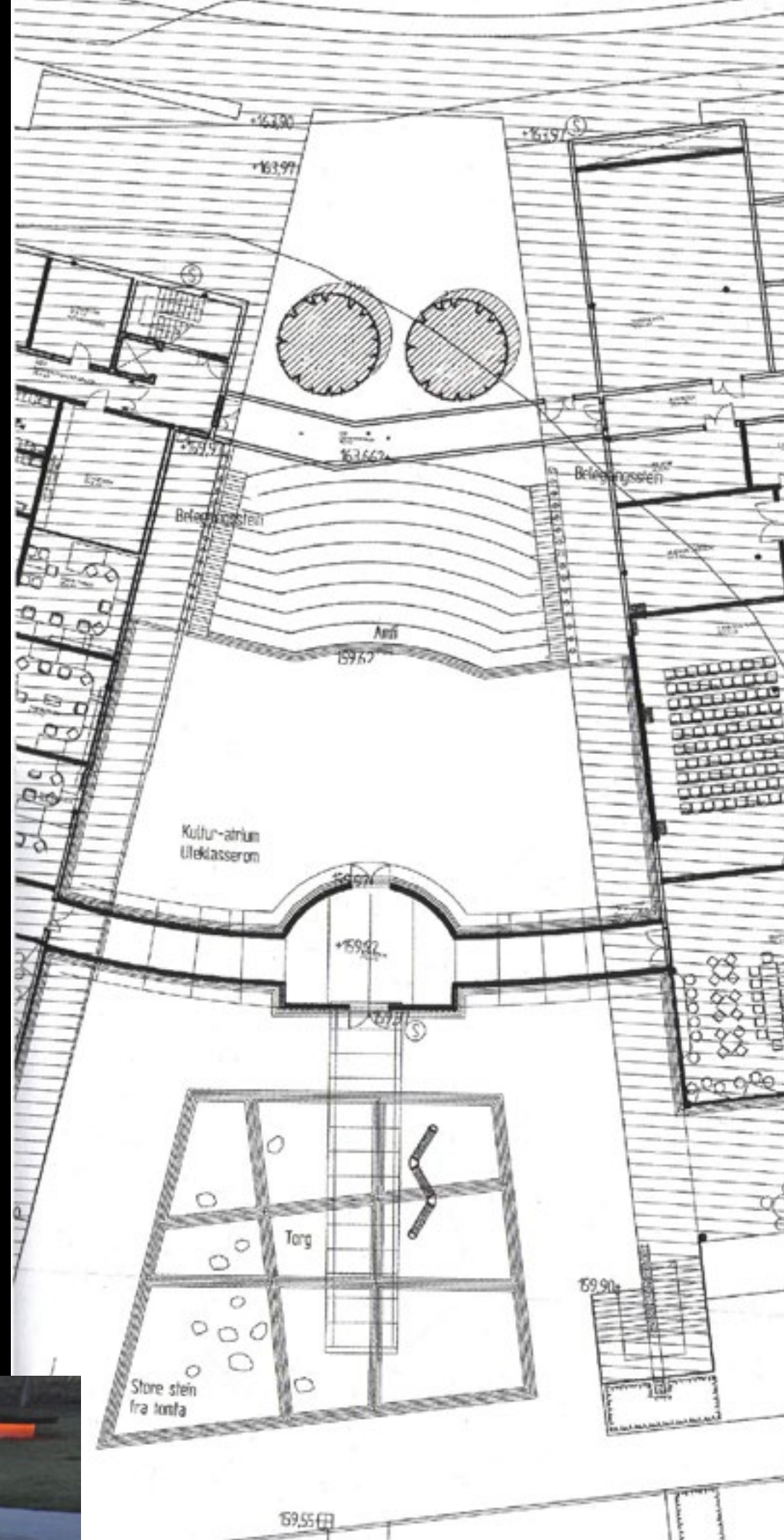

Original plan

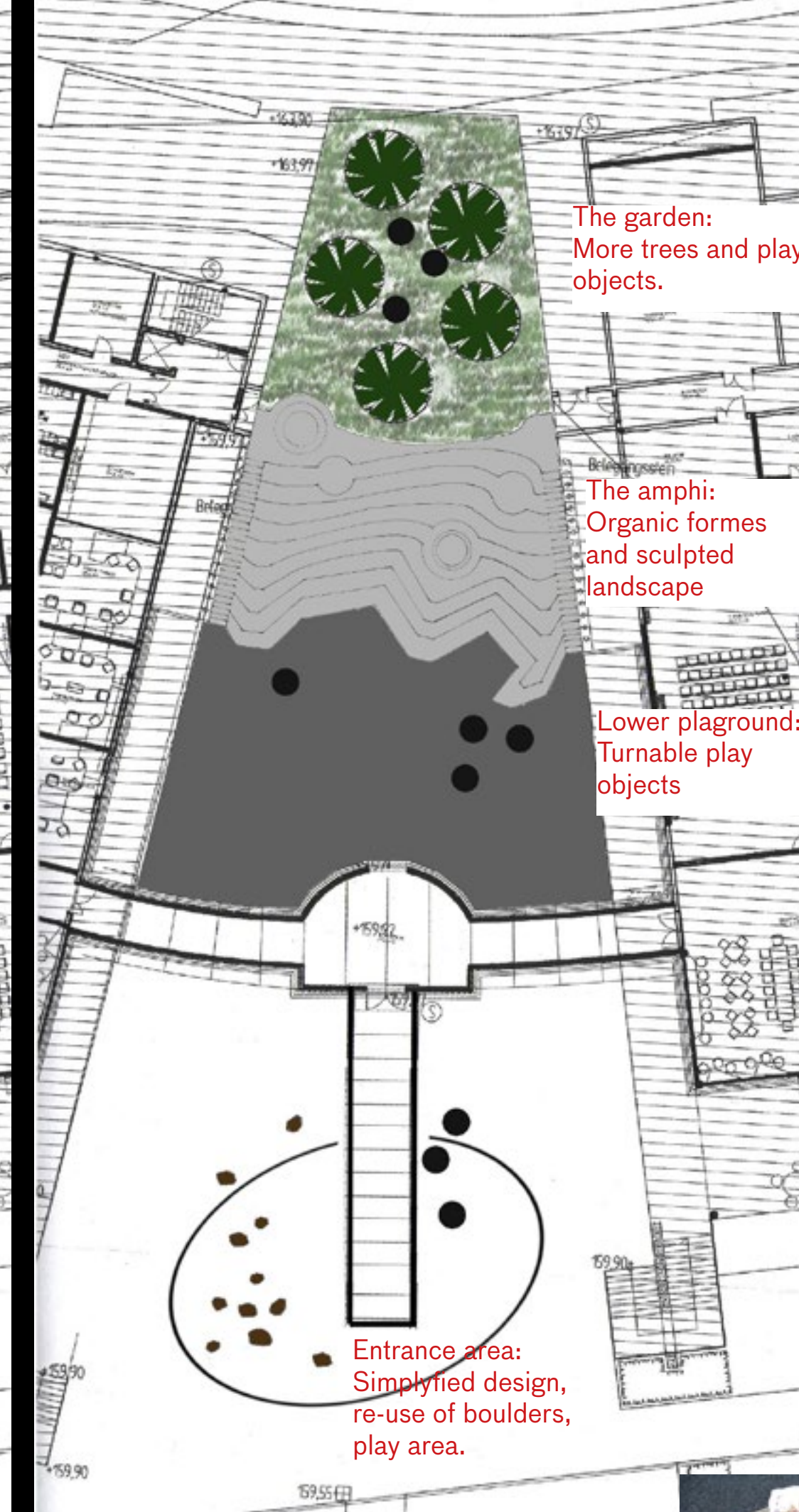

The art project plan

The garden:
 More trees and play objects.

The amphi:
 Organic formes and sculpted landscape

Lower playground:
 Turnable play objects

Entrance area:
 Simplified design, re-use of boulders, play area.



Children love to turn, turn, turn...!

